

Features

- All parts required for horizontal installation on steel door (e.g. guide rail, guide roller, stop device, etc.) are included in standard component.
- Long life time achieved by endless fluid frictional resistance type braking mechanism.
- The product can be used for both left and right hand sliding doors and can be easily converted between left and right by simple adjustment.
- Quick and easy installation without any special tool.



Specifications

right and left handed opening

Model		NSC-C48-22	NSC-C48-31
Applicable doors	Weight [kg]	10-80	
	Width [mm]	700-1,200	1,200-1,600
Max. stroke [mm]		1,500	
Closing drive system		Spiral spring type	
Controlling system		Fluid friction resistance type	
Controlling time		7-11 seconds (with a door-opening distance of 900mm)	
Initial opening force [N]		5.5 (Door weight 10kg), 9.2 (Door weight 80kg)	
Durability		More than 1 million open/close operations	
Control device		SC-C08	
Pull spring		PS-04A	
Rail length [m]		2.2	3.1

Part details

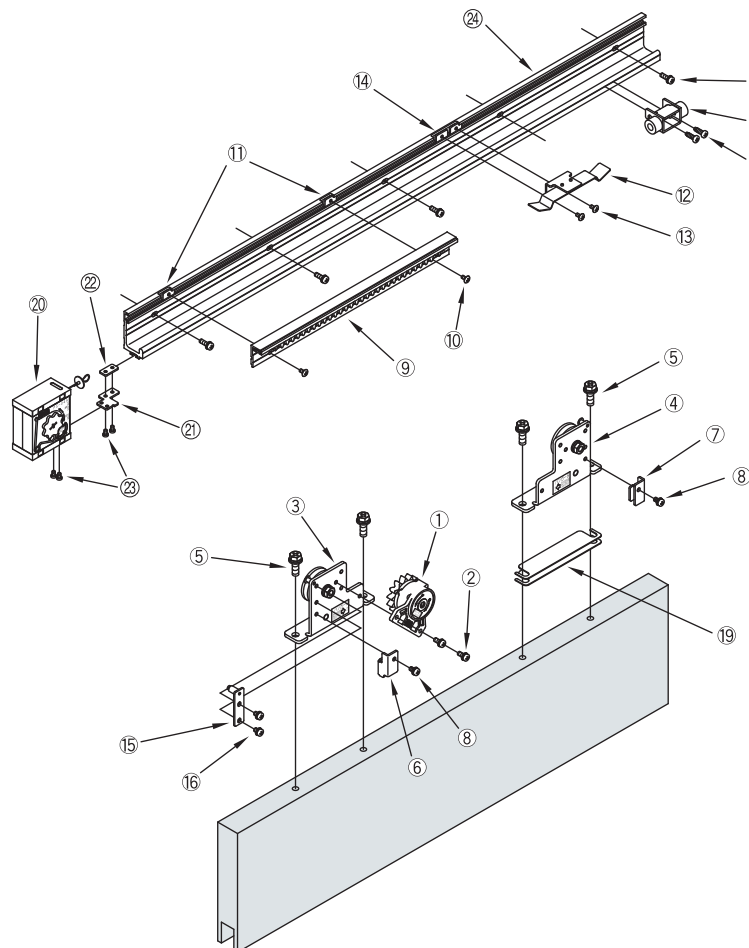

No.	Part	Q'ty	Remark
①	Control device	1	
②	M5×12 pan head screw	2	For control device
③	Hanger A	1	
④	Hanger B	1	For hanger
⑤	M8×25 cross recessed hexagon head bolt	4	
⑥	Door retaining fitting Hanger A	1	
⑦	Door retaining fitting Hanger B	1	Door retention
⑧	M5×8 pan head screw	2	
⑨	Control rack set	1	
⑩	M4×8 truss head screw	2	For control rack
⑪	Plate nut	2	
⑫	Plate spring	1	
⑬	M4×8 truss head screw	2	
⑭	Plate nut	2	For stop device
⑮	Stop roller	1	
⑯	M5×8 pan head screw	2	
⑰	Door stopper	1	
⑱	φ5X16 pan head tapping screw	2	For door stopper
⑲	Height adjusting plate (t = 1.0)	4	
⑳	Pull spring	1	
㉑	Pull spring bracket	1	
㉒	Plate nut	1	For pull spring
㉓	M4×6 pan head screw	4	
㉔	Rail L = 2200 [L = 3100]	1	
㉕	M5×16 pan head screw	8[11]	For rail
	φ5×30 truss head tapping screw	8[11]	

