

Model		Door size applicable (mm)			Door weight (kg)	Closing force (N·m)	Spring set system	Max. opening angle	Indicating label
		W	H	D					
A-8KHR	Right-hand opening	800 max.	2000 max.	36 min.	50 max.	6.9	Roll-in system	180° right or left one-side opening	R : Green L : Yellow
A-8KHL	Left-hand opening								

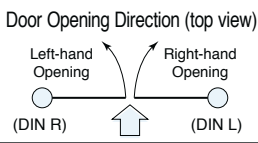

Top Pivot	Receptive Base
N-21B	U-2N

*This diagram shows the right-hand type.

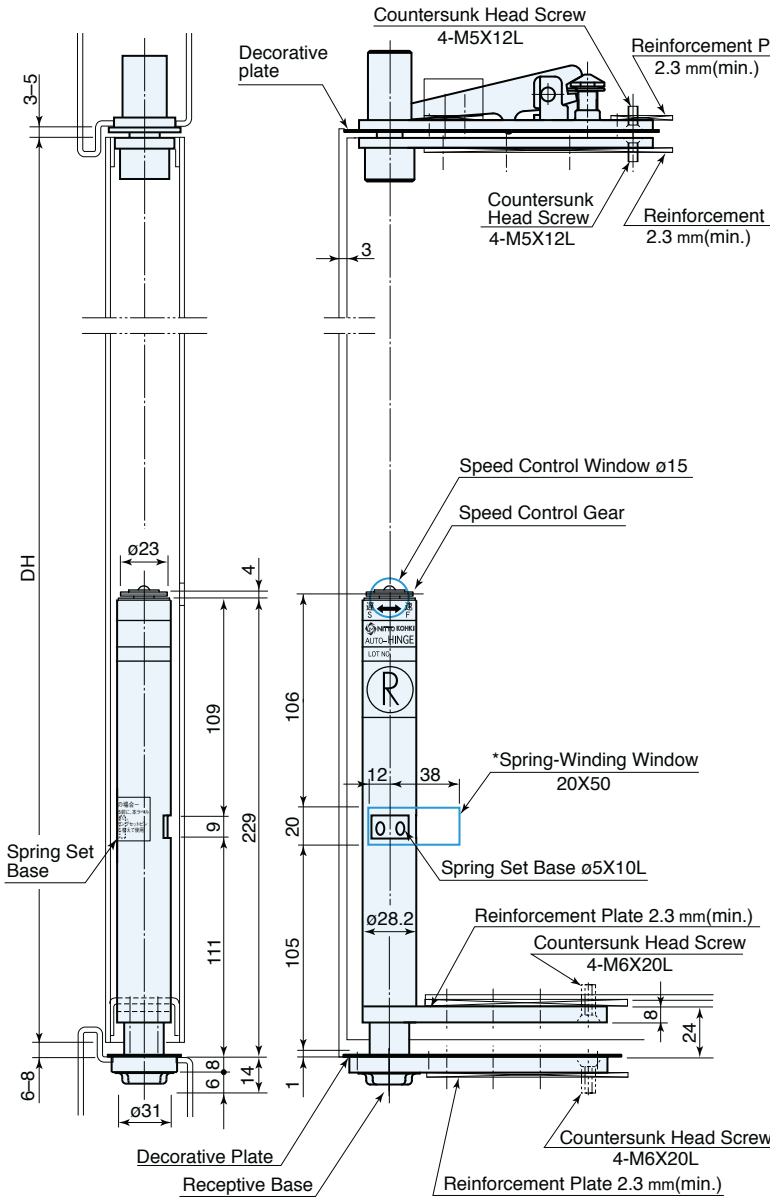

In the case of 90° opening

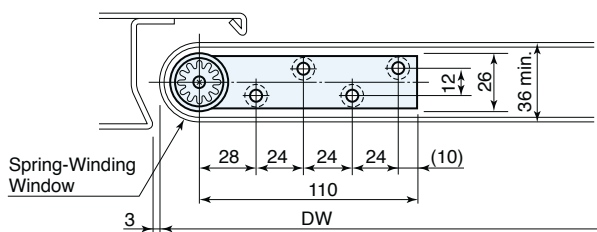

N-21B Top Pivot

The head shape of the adjusting screw is octagonal width across flat 17.

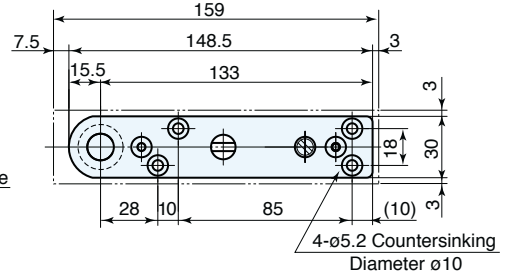

Upper Frame

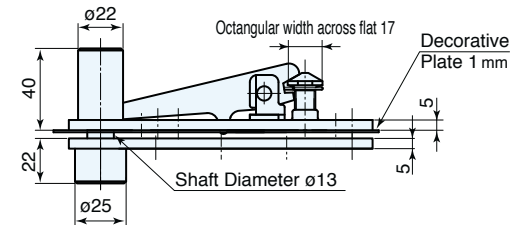

Door Side

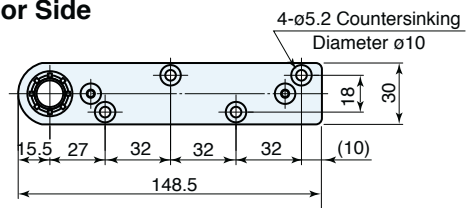

U-2N Receptive Base

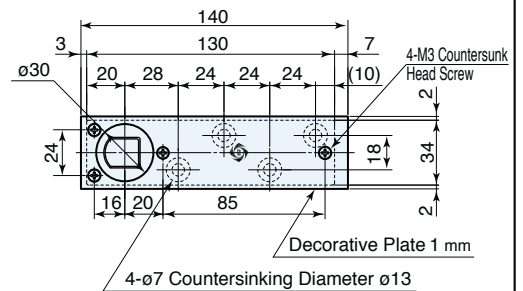

Spring Set Pin: 1 piece

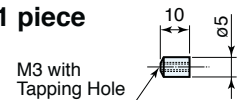

Mounting size of U-2N Receptive Base

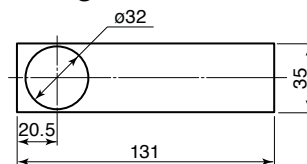

Unit: mm

REMARKS

1. This diagram shows the installation example of right-hand opening doors. There is a spring winding-window on both sides of hinge main body.
2. To cover the door cutouts for speed control window and spring-winding window, use the decorative rubber plate supplied with the product. (See page 29)

Model		Door size applicable (mm)			Door weight (kg)	Closing force (N·m)	Spring set system	Max. opening angle	Indicating label
		W	H	D					
A-12HR	Right-hand opening	1200 max.	2100 max.	40 min.	100 max.	15.7	Roll-in system	180° right or left one-side opening	R : Green L : Yellow
A-12HL	Left-hand opening								

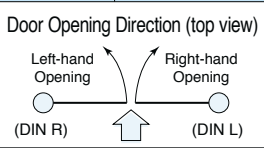

Top Pivot	Receptive Base
N-21B	U-3SN

*This diagram shows the right-hand type.

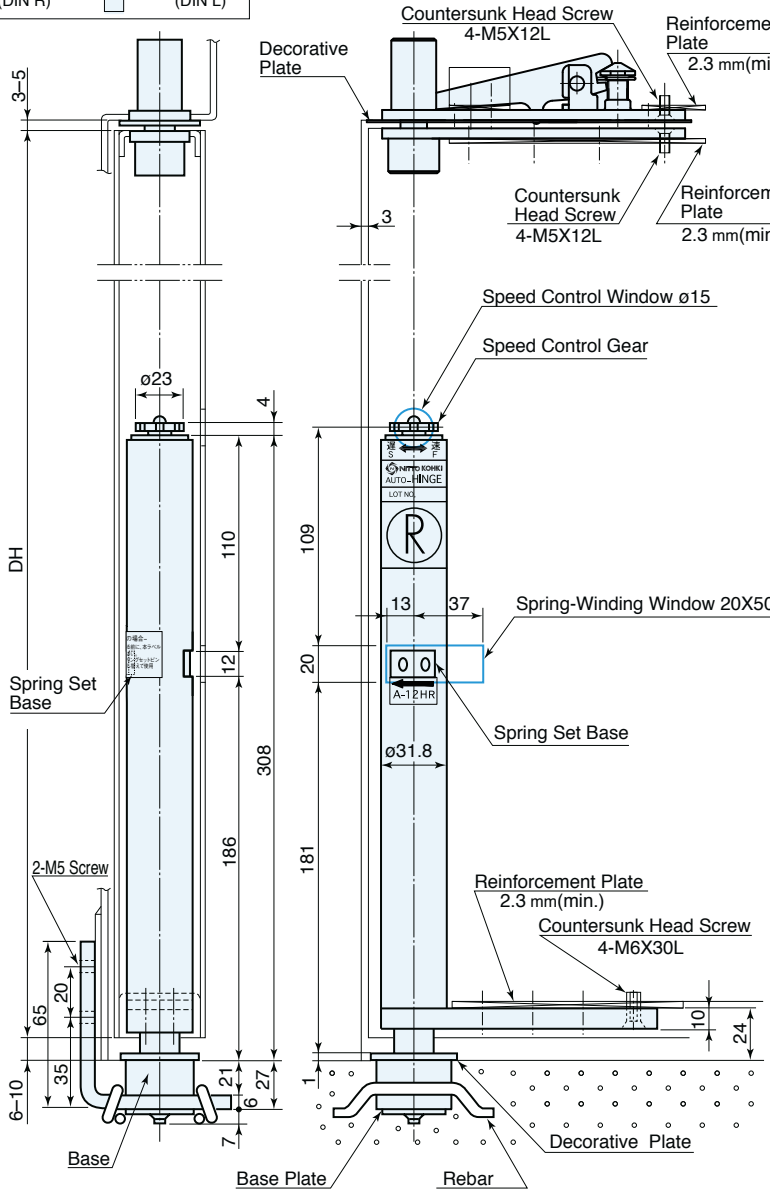

N-21B Top Pivot

The head shape of the adjusting screw is octagonal width across flat 17.

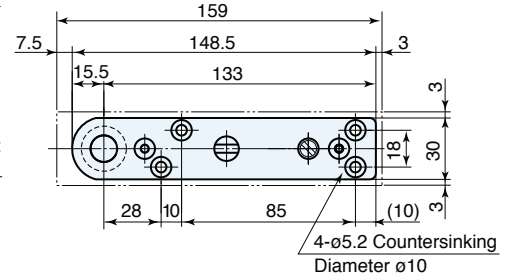

Upper Frame

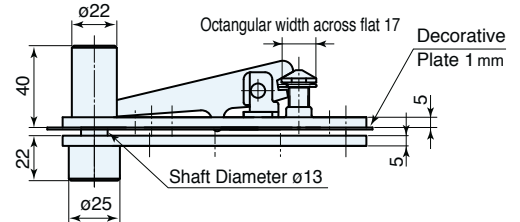

Door Side

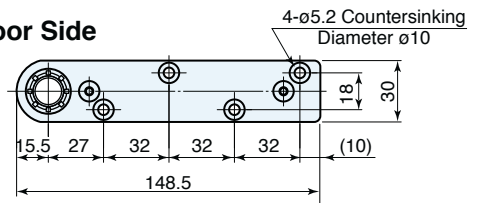

U-3SN Receptive Base

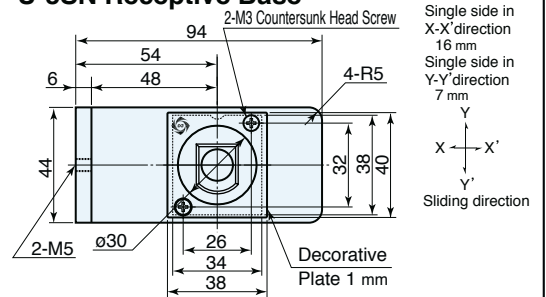

Spring Set Pin: 1 piece



In the case of 90° opening

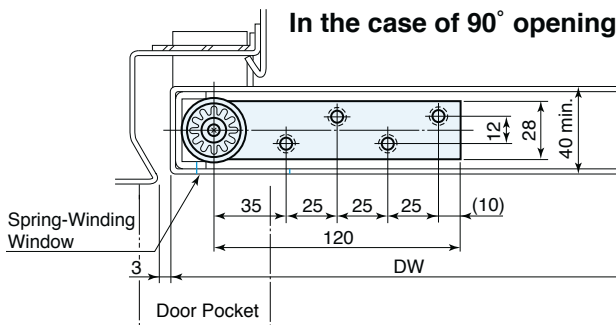

In the case of 180° opening

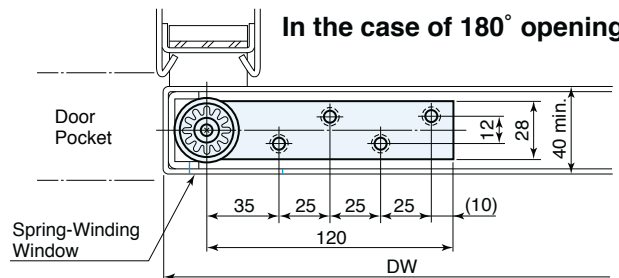

Unit: mm

REMARKS

1. This diagram shows the installation example of right-hand opening doors. There is a spring winding-window on both sides of hinge main body.
2. The receptive base must be adjusted and centered by using a plumb bob from the top pivot. The base must be firmly welded onto the base plate.
3. To cover the door cutouts for speed control window and spring-winding window, use the decorative rubber plate supplied with the product. (See page 29)

Model		Door size applicable (mm)			Door weight (kg)	Closing force (N·m)	Spring set system	Max. opening angle	Indicating label
		W	H	D					
A-14HR	Right-hand opening	1400 max.	2100 max.	40 min.	130 max.	19.7	Roll-in system	180° right or left one-side opening	R : Green L : Yellow
A-14HL	Left-hand opening								

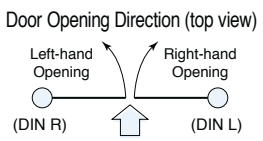

Top Pivot	Receptive Base
N-21B	U-3SN

*This diagram shows the right-hand type.

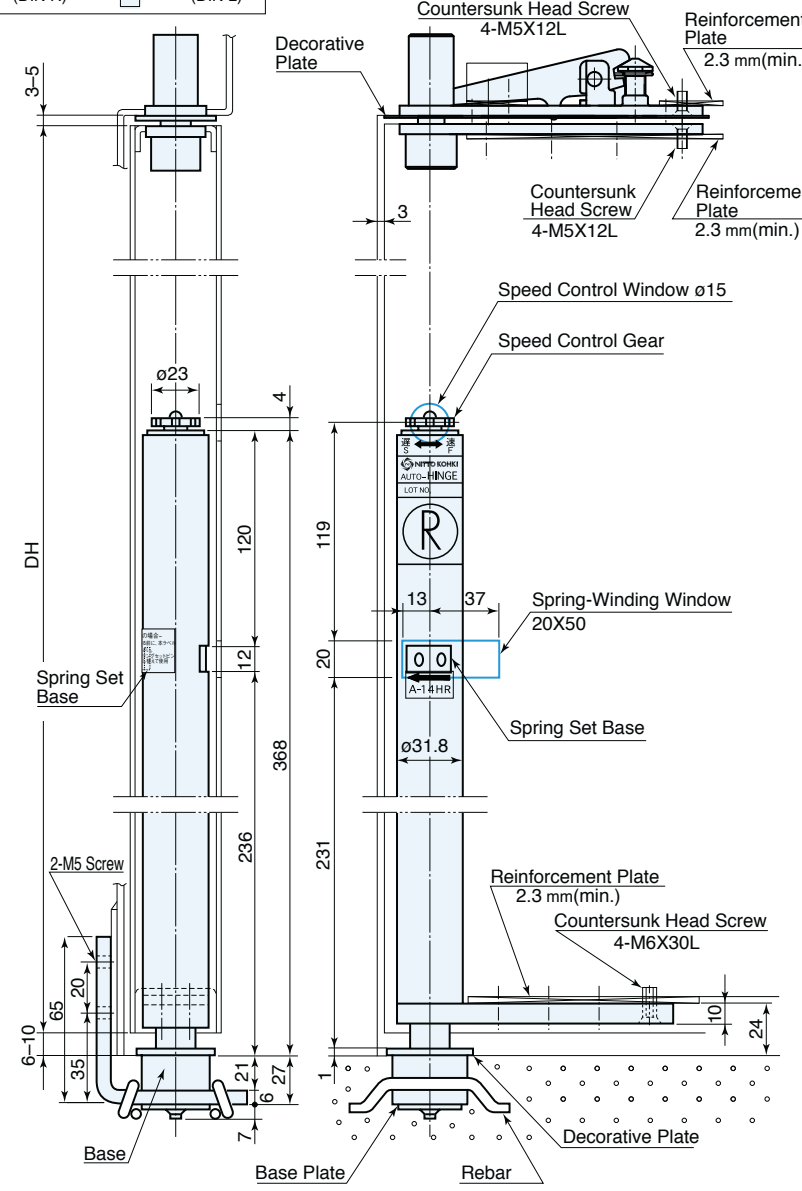

N-21B Top Pivot

The head shape of the adjusting screw is octagonal width across flat 17.

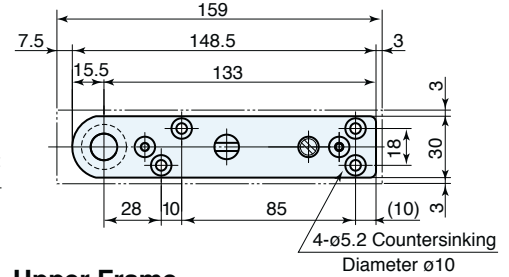

Upper Frame

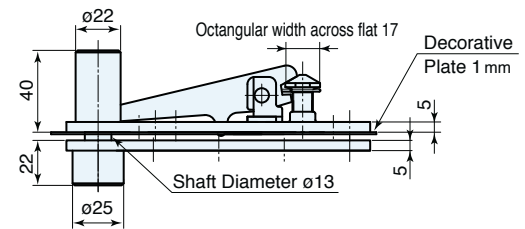

Door Side

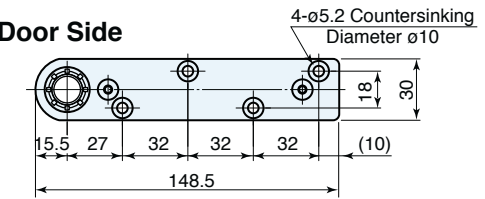

U-3SN Receptive Base

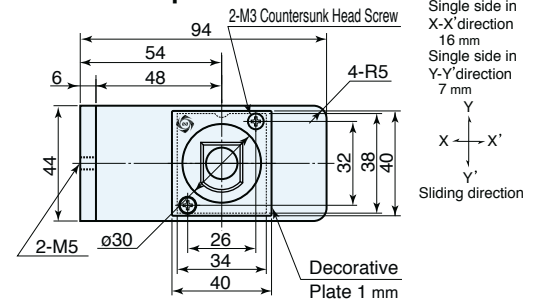

Spring Set Pin: 1 piece

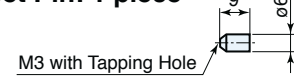

In the case of 90° opening

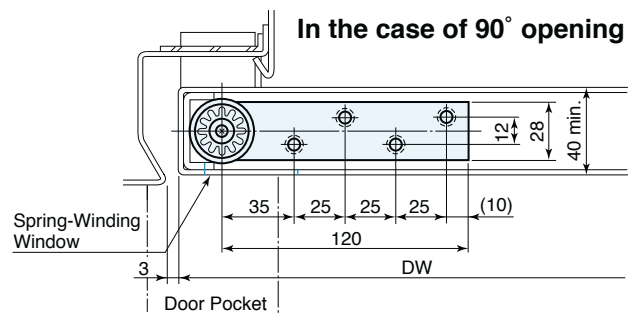

In the case of 180° opening

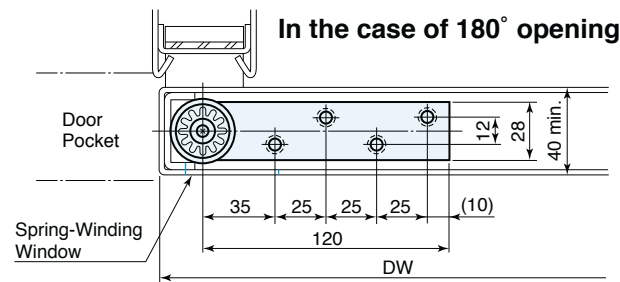

Unit: mm

REMARKS

1. This diagram shows the installation example of right-hand opening doors. There is a spring winding-window on both sides of hinge main body.
2. The receptive base must be adjusted and centered by using a plumb bob from the top pivot. The base must be firmly welded onto the base plate.
3. To cover the door cutouts for speed control window and spring-winding window, use the decorative rubber plate supplied with the product. (See page 29)

Model		Door size applicable (mm)			Door weight (kg)	Closing force (N·m)	Spring set system	Max. opening angle	Indicating label
		W	H	D					
A-16HR	Right-hand opening	1600 max.	2400 max.	45 min.	160 max.	24.6	Roll-in system	180° right or left one-side opening	R : Green L : Yellow
A-16HL	Left-hand opening								

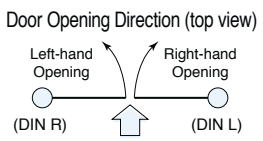

Top Pivot	Receptive Base
N-22B	U-3SN

*This diagram shows the right-hand type.

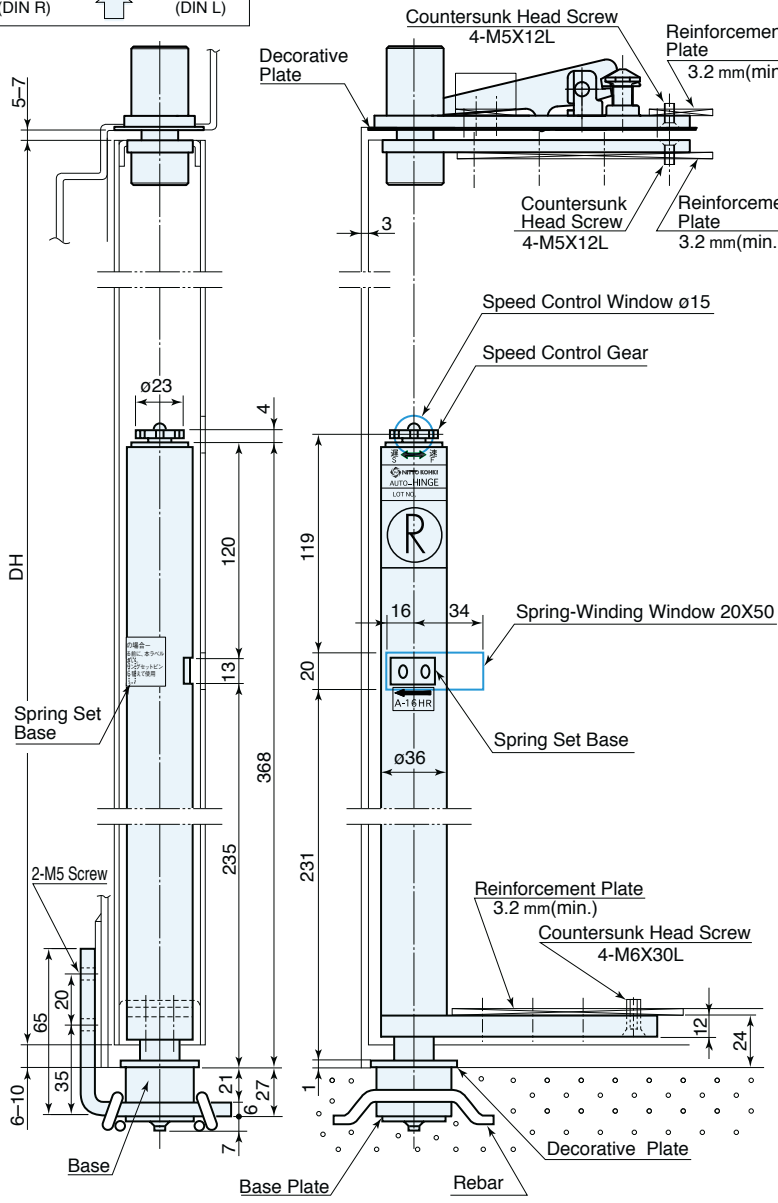

N-22B Top Pivot

The head shape of the adjusting screw is octagonal width across flat 17.

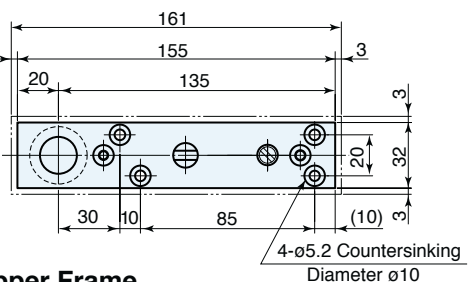

Upper Frame

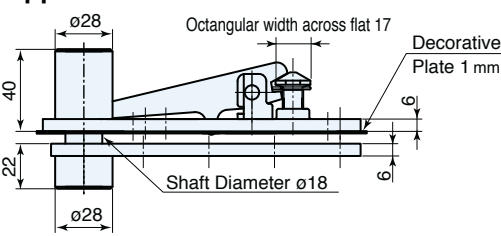

Door Side

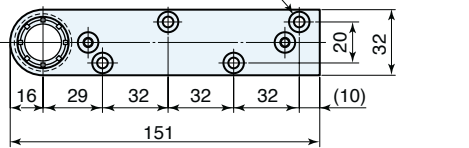

U-3SN Receptive Base

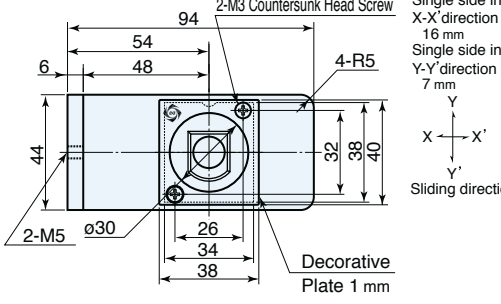

Spring Set Pin: 1 piece

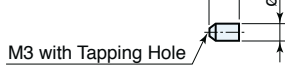

In the case of 90° opening

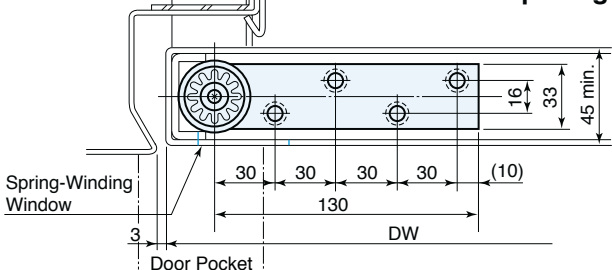

In the case of 180° opening

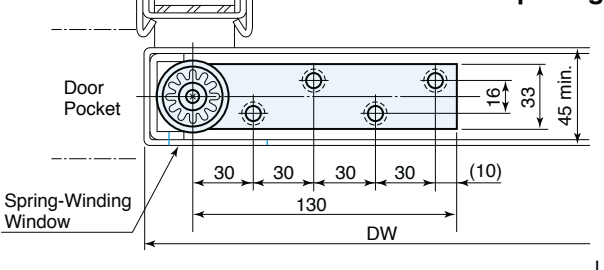

Unit: mm

REMARKS

1. This diagram shows the installation example of right-hand opening doors. There is a spring winding-window on both sides of hinge main body.
2. The receptive base must be adjusted and centered by using a plumb bob from the top pivot. The base must be firmly welded onto the base plate.
3. To cover the door cutouts for speed control window and spring-winding window, use the decorative rubber plate supplied with the product. (See page 29)

Model		Door size applicable (mm)			Door weight (kg)	Closing force (N·m)	Spring set system	Max. opening angle	Indicating label
		W	H	D					
A-22R	Right-hand opening	2200 max.	2400 max.	50 min.	240 max.	49.1	Roll-in system	180° right or left one-side opening	R : Green L : Yellow
A-22L	Left-hand opening								

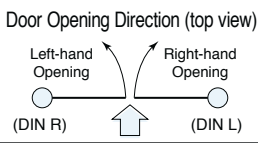

Top Pivot	Receptive Base
N-22B	U-6SN

*This diagram shows the right-hand type.

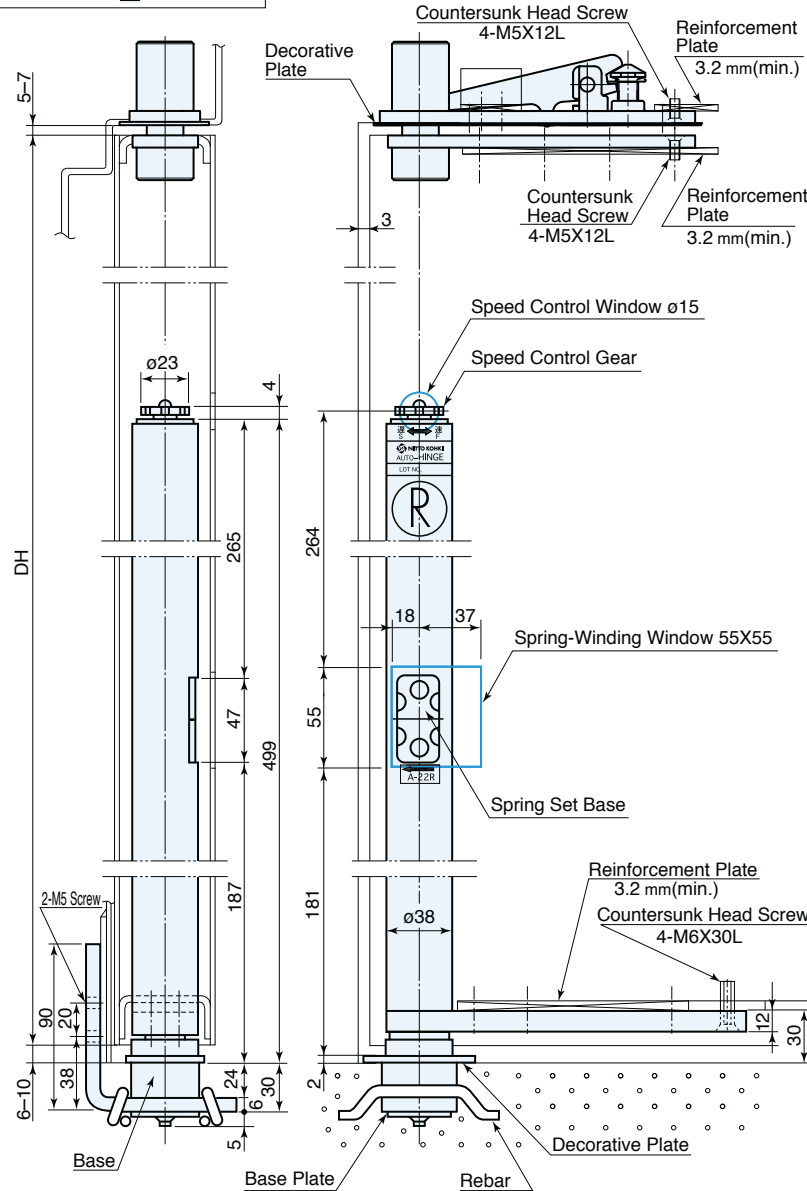

N-22B Top Pivot

The head shape of the adjusting screw is octagonal width across flat 17.

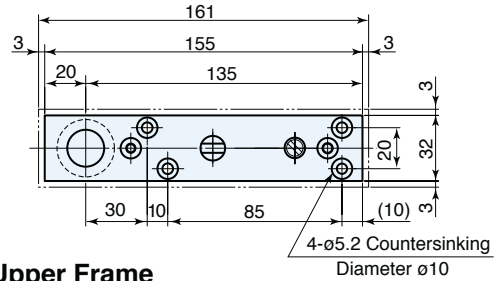

Upper Frame

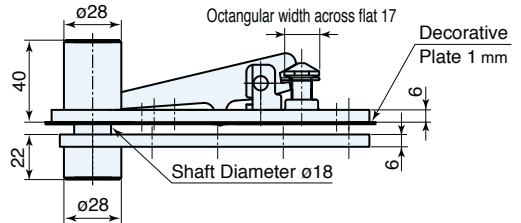

Door Side

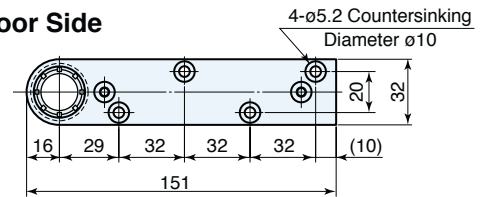

U-6SN Receptive Base

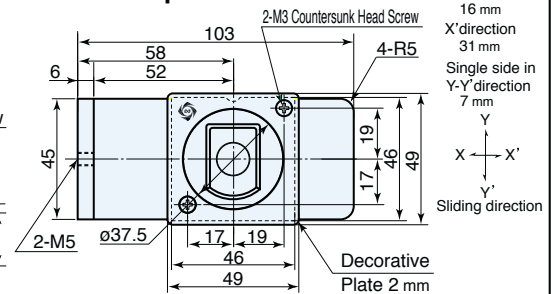

Spring Set Pin: 2 pieces

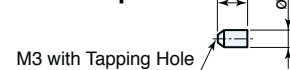

In the case of 90° opening

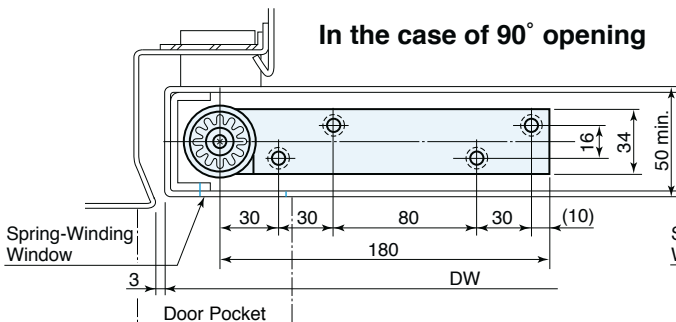

In the case of 180° opening

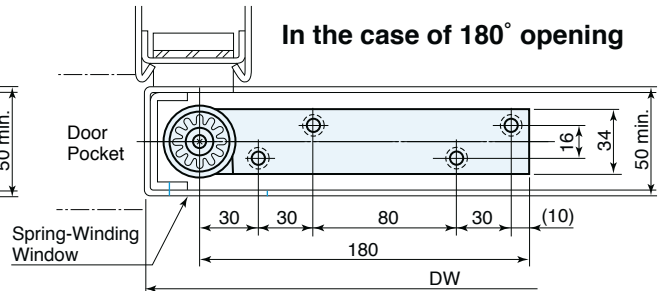

Unit: mm

REMARKS

1. This diagram shows the installation example of right-hand opening doors.
2. The receptive base must be adjusted and centered by using a plumb bob from the top pivot. The base must be firmly welded onto the base plate.
3. To cover the door cutouts for speed control window and spring-winding window, use the decorative rubber plate supplied with the product. (See page 29)

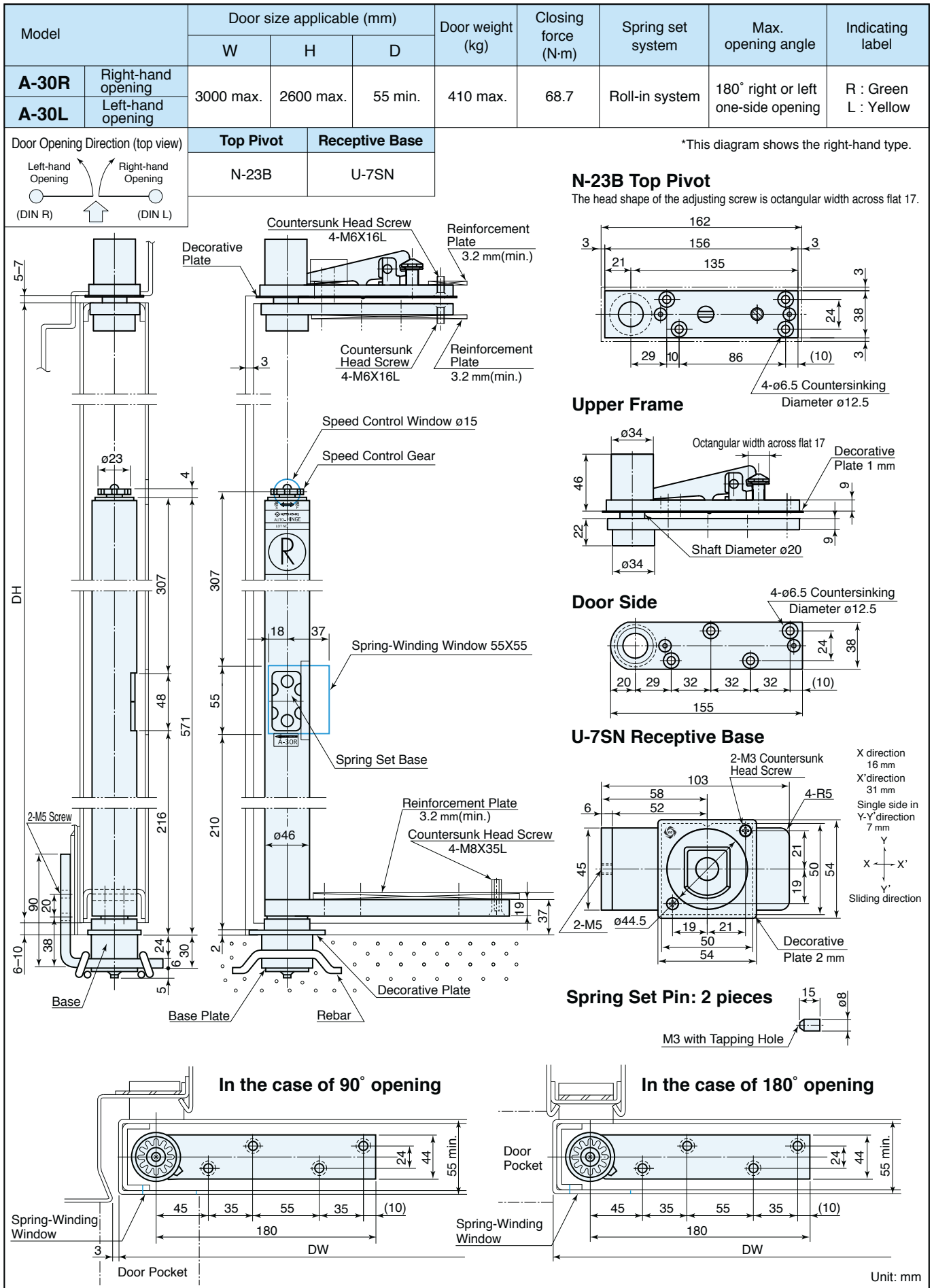

REMARKS

1. This diagram shows the installation example of right-hand opening doors.
2. The receptive base must be adjusted and centered by using a plumb bob from the top pivot. The base must be firmly welded onto the base plate.
3. To cover the door cutouts for speed control window and spring-winding window, use the decorative rubber plate supplied with the product. (See page 29)

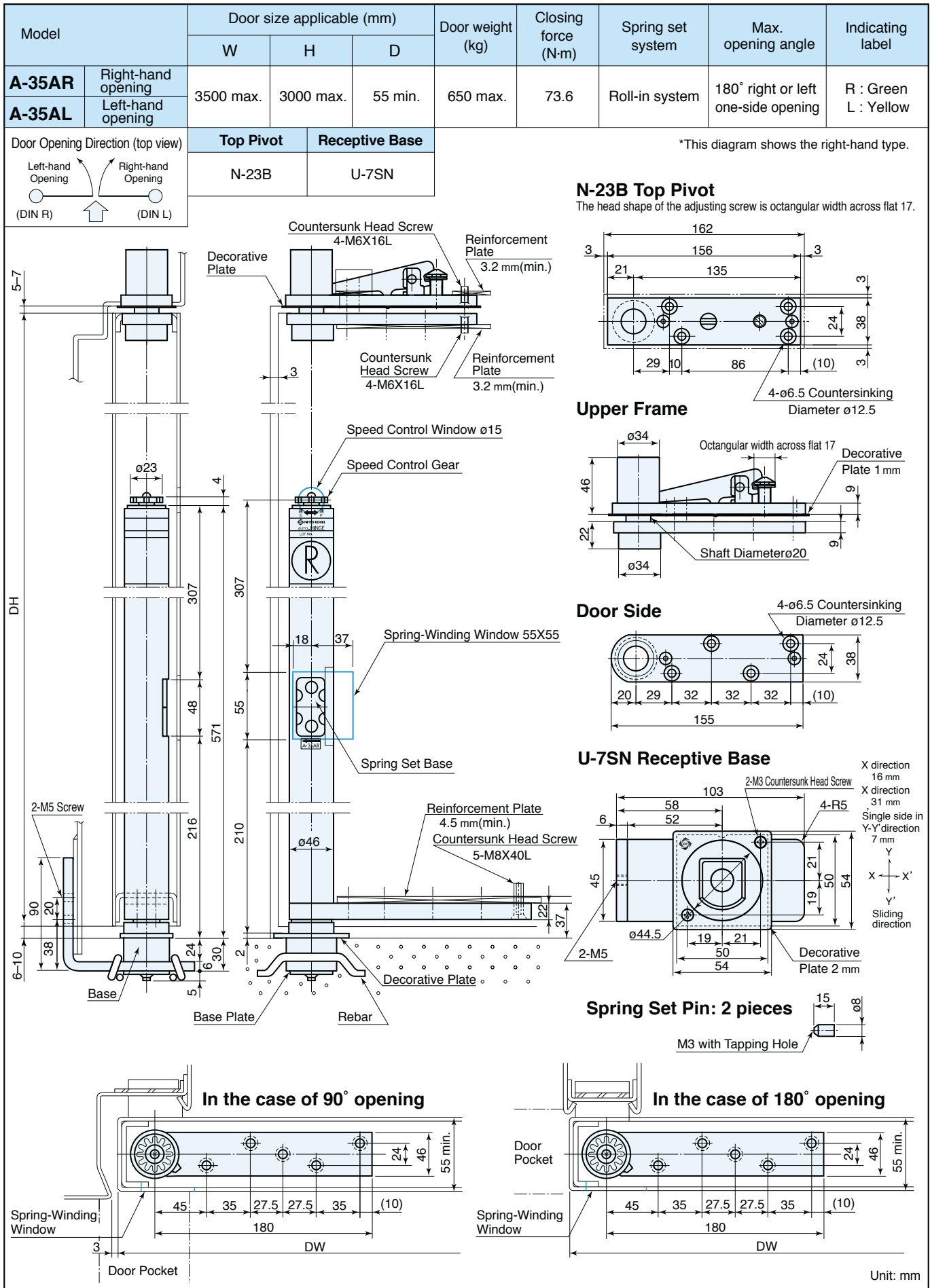

REMARKS

1. This diagram shows the installation example of right-hand opening doors.
2. The receptive base must be adjusted and centered by using a plumb bob from the top pivot. The base must be firmly welded onto the base plate.
3. To cover the door cutouts for speed control window and spring-winding window, use the decorative rubber plate supplied with the product. (See page 29)

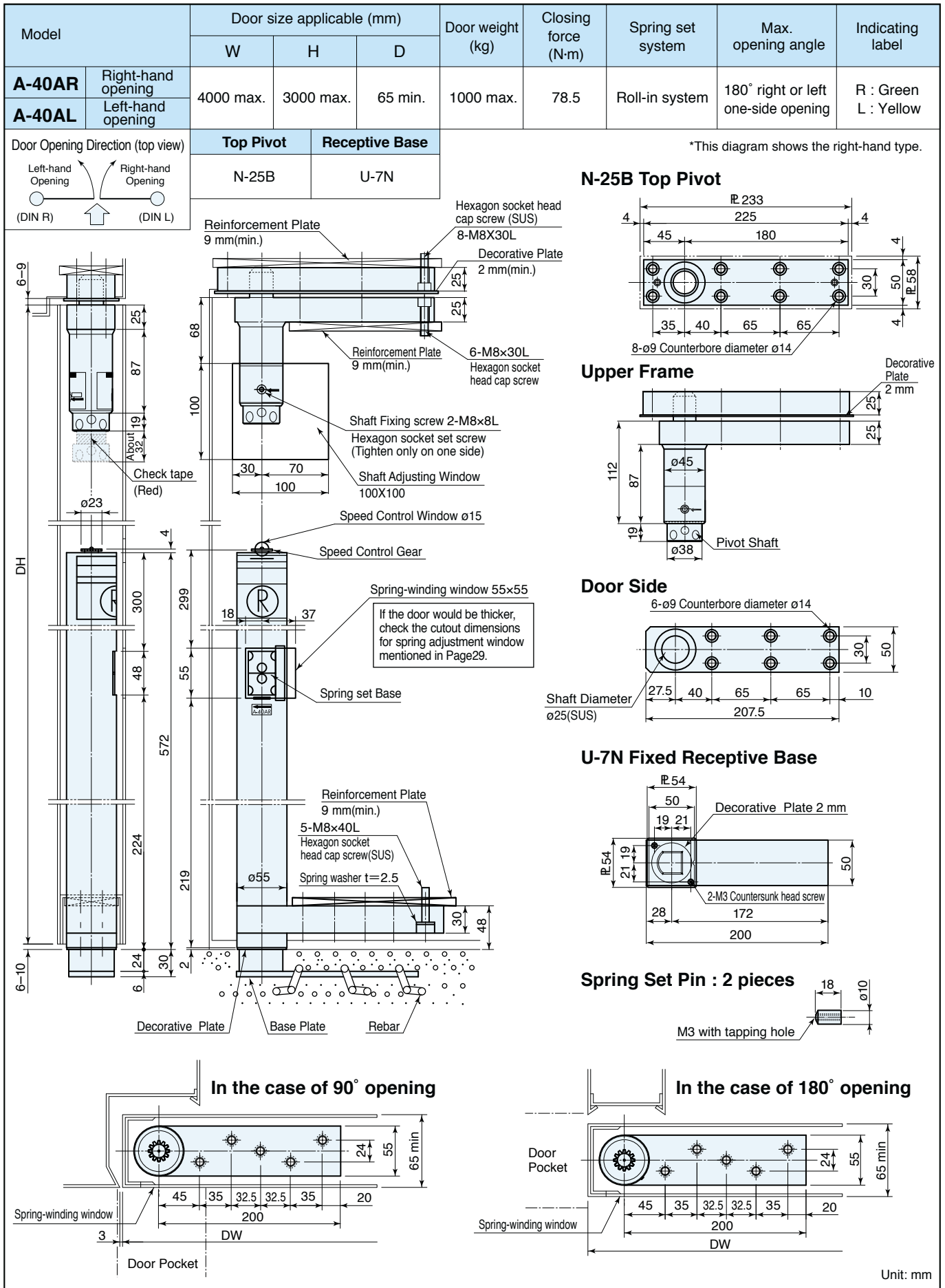

REMARKS

1. This diagram shows the installation example of right-hand opening doors.
2. The receptive base must be adjusted and centered by using a plumb bob from the top pivot. The base must be firmly welded onto the base plate.
3. To cover the door cutouts for speed control window and spring-winding window, use the decorative rubber plate supplied with the product. (See page 29) Prepare a decorative cover for shaft fixing window of the top pivot.
4. Large force will be applied to each mounting point. Provide sufficient reinforcement.
5. Fix the top pivot securely as turning the shaft upward. Firmly tighten the shaft fixing screws.